

TYP. POST DETAILS

TRUSS SIZE	POST HOLE DIAMETER	POST HOLE DEPTH	CONC. lbs
10'-24'	18" dia	36" - 40"	320lbs
25'-36'	20" dia	36" - 40"	480lbs
37'-50'	24" dia	36" - 40"	640lbs

STANDARD MATERIALS INCLUDED
 ROOF PANELS, RIDGE CAP & SCREWS
 2x6 PURLINS
 1x6 FASCIA BOARD
 TRUSSES AND HARDWARE
 POST & REBAR

ENSURE FREE DRAINING SOIL
@ EA. FOOTING

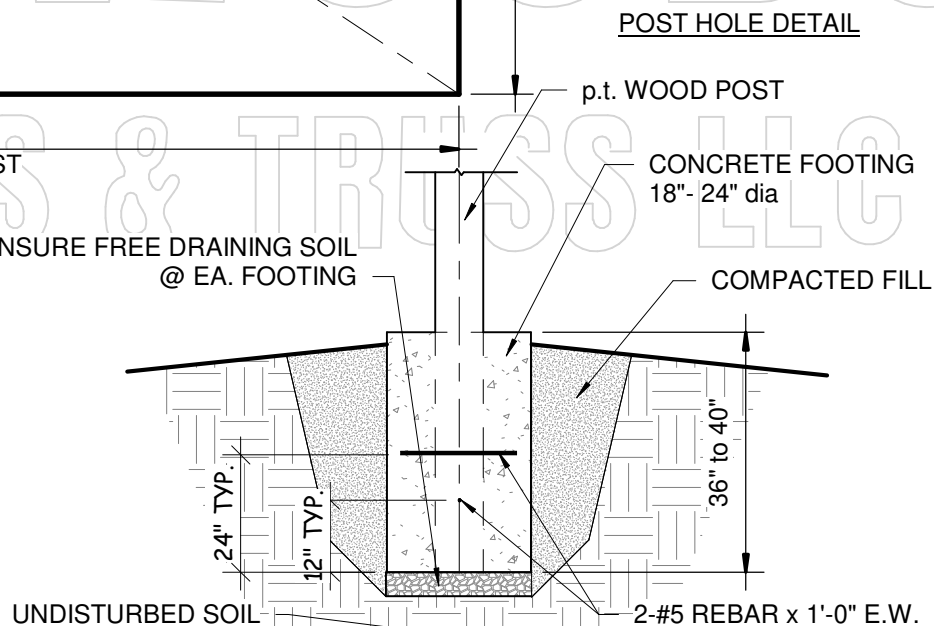

DISCLAIMER:

DIY INSTRUCTIONS FOR VISUAL AID ONLY
 PLEASE CONSULT LOCAL BUILDING
 DEPARTMENT FOR CODE SPECIFICATIONS

BACKWOODS BUILDINGS & TRUSS LLC

1240 S. BLVD. CHIPLEY FLORIDA, 32428
 WEBSITE: www.backwoodsbuildings.net
 PHONE NO : (850)-676-4903

BACKWOODS
 BUILDINGS & TRUSS LLC

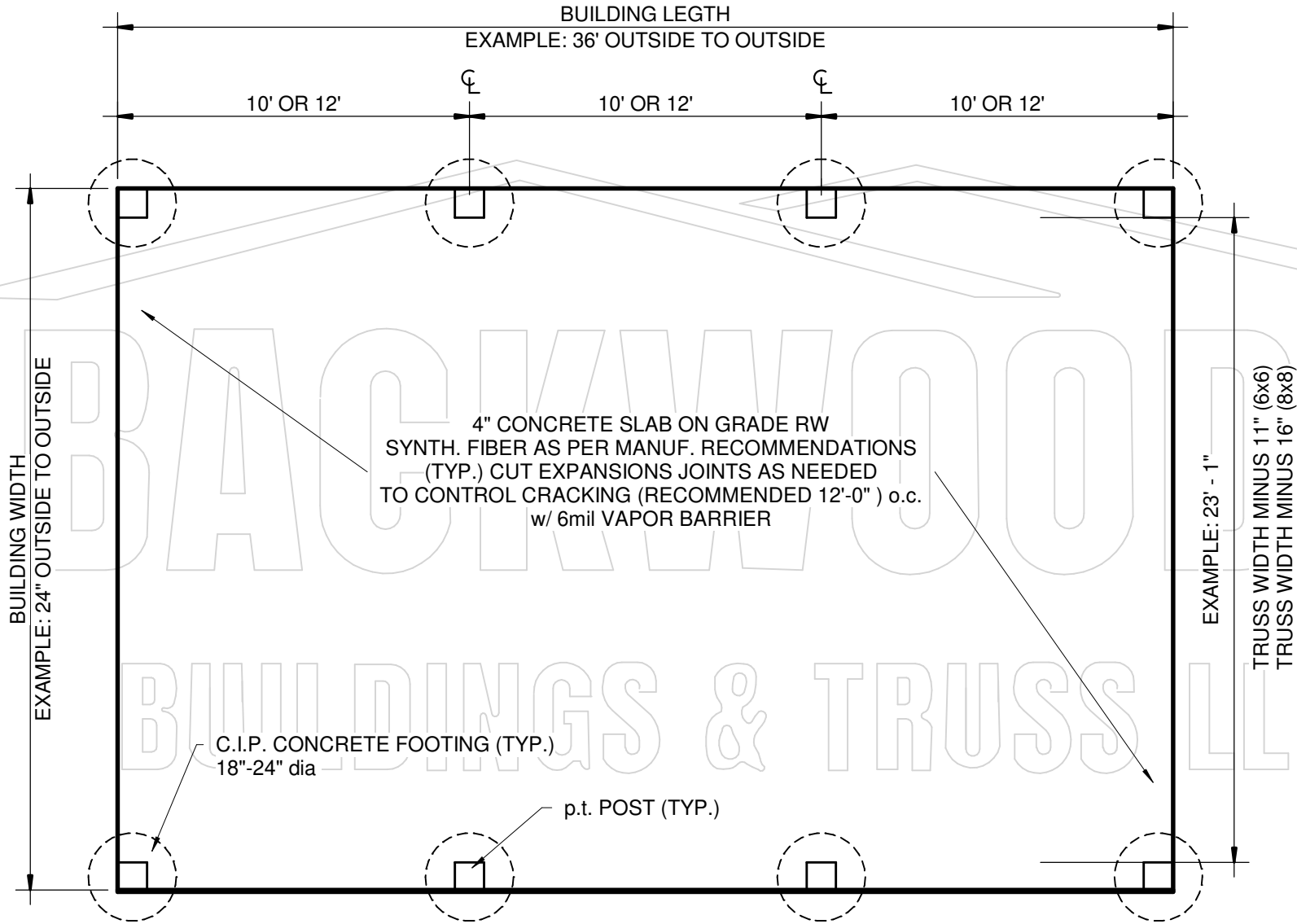

DISCLAIMER:
DIY INSTRUCTIONS FOR VISUAL AID ONLY
PLEASE CONSULT LOCAL BUILDING
DEPARTMENT FOR CODE SPECIFICATIONS

BACKWOODS BUILDINGS & TRUSS LLC
1240 S. BLVD. CHIPLEY FLORIDA, 32428
WEBSITE: www.backwoodsbuildings.net
PHONE NO : (850)-676-4903

BACKWOODS
BUILDINGS & TRUSS LLC

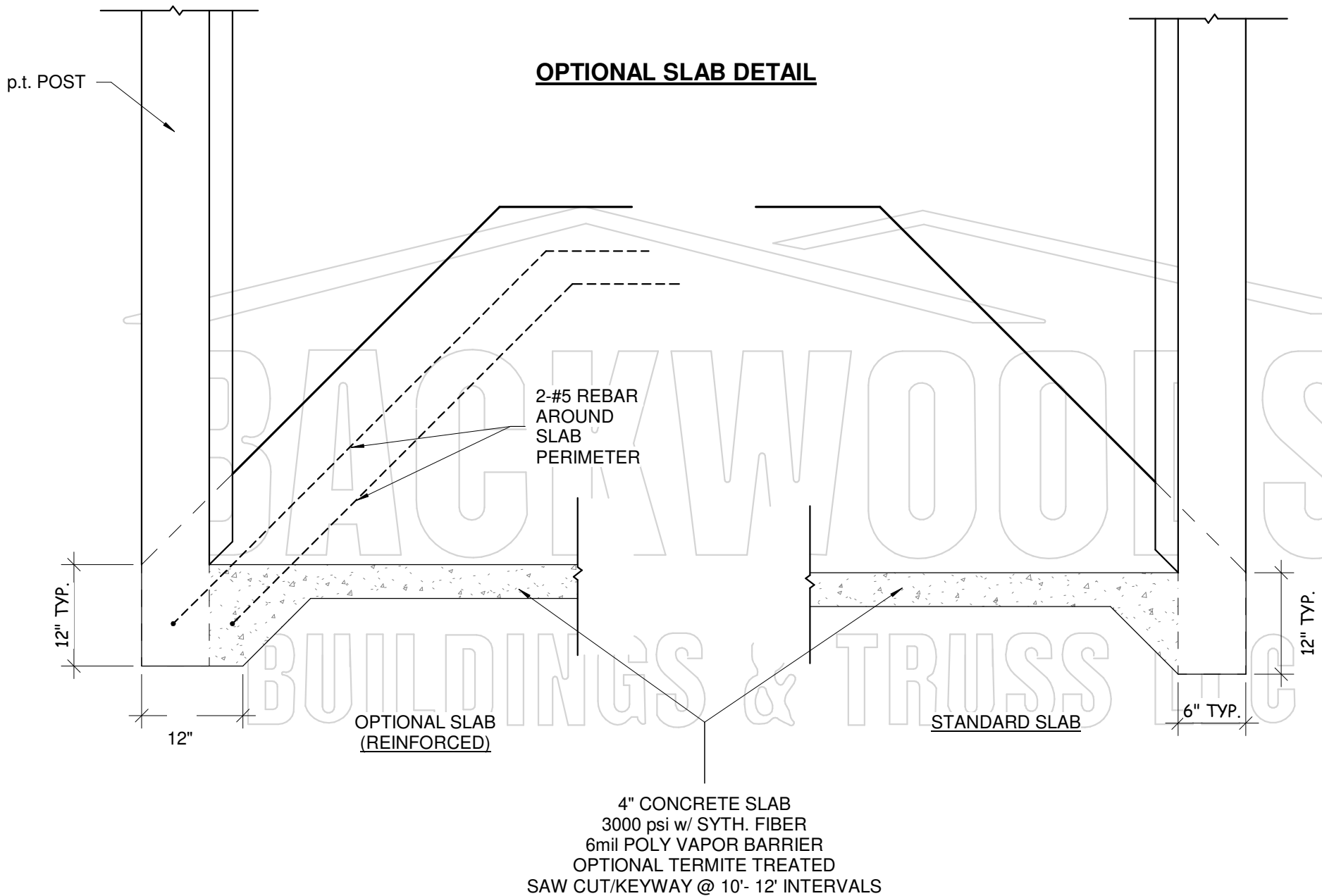

CONCRETE SLAB TO BE POURED AFTER POSTS ARE SET AND OPEN POLE BARN IS FINISHED IF POSSIBLE

DISCLAIMER:
DIY INSTRUCTIONS FOR VISUAL AID ONLY
PLEASE CONSULT LOCAL BUILDING
DEPARTMENT FOR CODE SPECIFICATIONS

BACKWOODS BUILDINGS & TRUSS LLC
1240 S. BLVD. CHIPLEY FLORIDA, 32428
WEBSITE: www.backwoodsbuildings.net
PHONE NO : (850)-676-4903

BACKWOODS
BUILDINGS & TRUSS LLC

PAGE NO.

3

TYP. GABLE TRUSS DETAIL

NOTE:
PRE-DRILL 1/2" PILOT
HOLES FOR LAG BOLTS

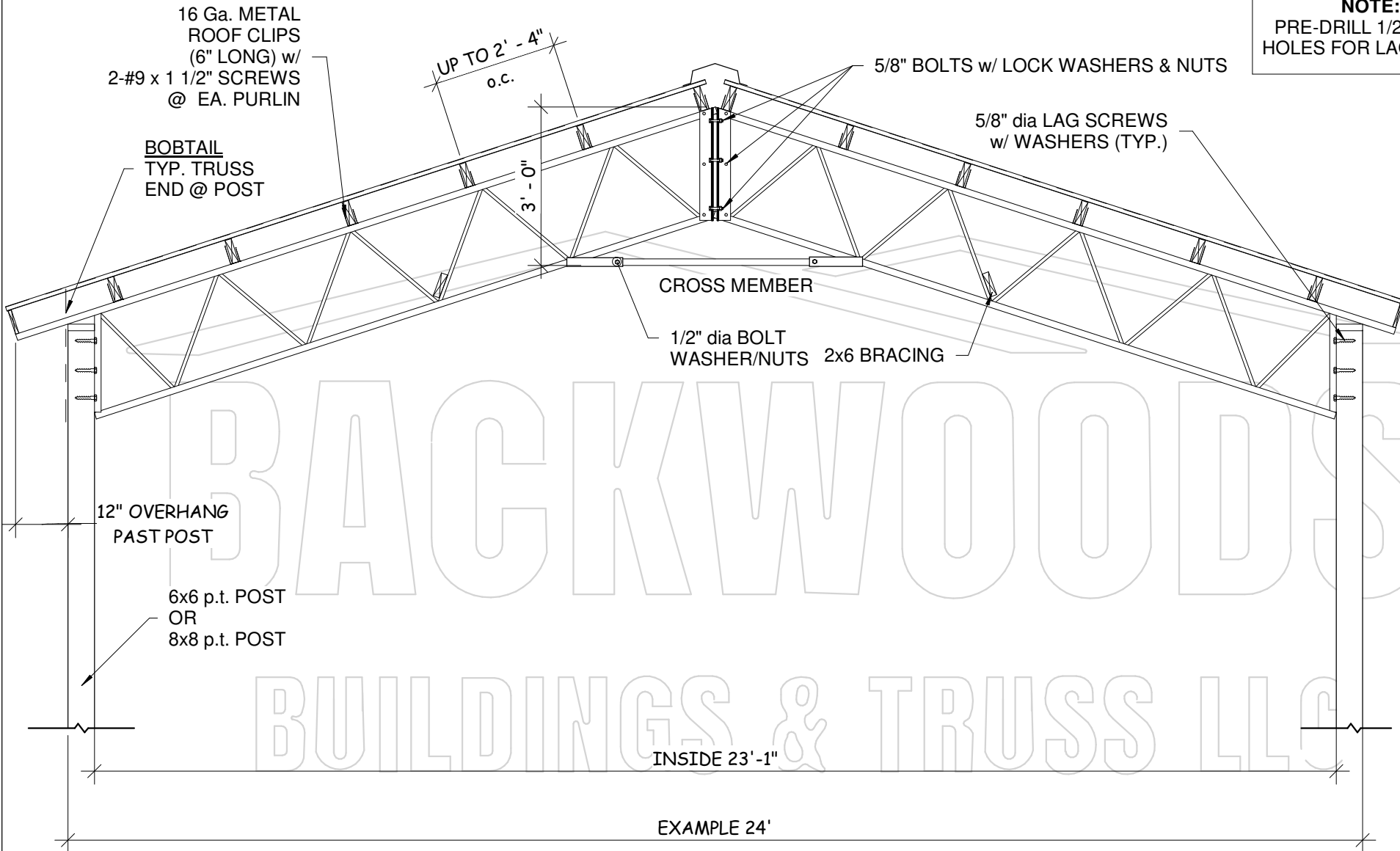

DISCLAIMER:
DIY INSTRUCTIONS FOR VISUAL AID ONLY
PLEASE CONSULT LOCAL BUILDING
DEPARTMENT FOR CODE SPECIFICATIONS

BACKWOODS BUILDINGS & TRUSS LLC
1240 S. BLVD. CHIPLEY FLORIDA, 32428
WEBSITE: www.backwoodsbuildings.net
PHONE NO : (850)-676-4903

BACKWOODS
BUILDINGS & TRUSS LLC

TYP. TRUSS DETAILS

TRUSS SPAN	TYP. POST SIZE	TRUSS DEPTH	TOP CHORD	WEB	TRUSS TO POST	TRUSS PEAK CONNECTION
10-31	6x6	16"	L 1.5 x 1.5 x 1/8"	L 1 x 1 x 1/8"	3- 5/8" dia LAGS w/ WASHERS	3-5/8" dia BOLTS w/ LOCK WASHERS & NUTS
32	6x6	16"	L 2 x 2 x 3/16"	L 1.5 x 1.5 x 1/8"	3- 5/8" dia LAGS w/ WASHERS	3-5/8" dia BOLTS w/ LOCK WASHERS & NUTS
33-50	8x8	20"	L 2 x 2 x 3/16"	L 1.5 x 1.5 x 1/8"	4- 5/8" dia LAGS w/ WASHERS	4-5/8" dia BOLTS w/ LOCK WASHERS & NUTS

PAGE NO.

LEVEL DETAIL

MEASURE FROM BENCHMARK TO GROUND
DEDUCT MEASUREMENT FROM PROPOSED
EAVE HEIGHT, REMAINDER IS MEASUREMENT UP
TO CUT POST. USE THIS MEASUREMENT ON ALL
POST TO ACHIEVE LEVEL POSTS.

MEASURE ALL CORNER POST FROM
BENCHMARK TO GROUND. IF MEASUREMENT
DIFFERS MORE THAN 12" SEE SLOPE DETAIL

8'

2'

CUT OFF LINE

LEVEL BENCHMARK

MEASURE ALL CORNER POST FROM
BENCHMARK TO GROUND. IF MEASUREMENT
DIFFERS MORE THAN 12" SEE SLOPE DETAIL

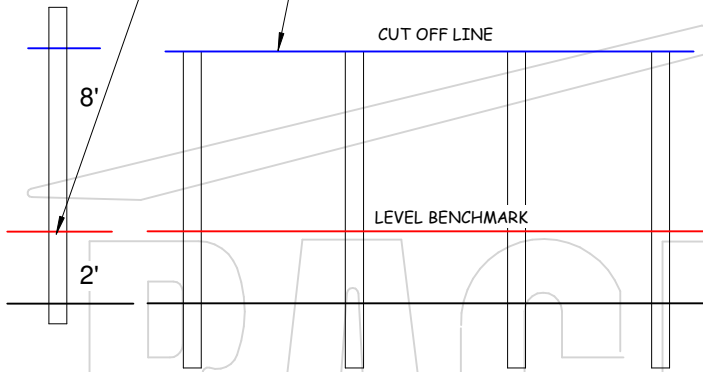

SLOPE DETAIL

MEASURE FROM BENCHMARK TO GROUND, IF MEASUREMENT CHANGES MORE THAN 12" EAVE HEIGHT CAN ONLY BE AS TALL AS POST WITH SHORTEST MEASUREMENT FROM BENCHMARK TO TOP OF POST

CUT OFF LINE

LEVEL BENCHMARK

SLOPE

8'

2'

10' w/ 2' CUT OFF

12' NO CUT

8'

4'

SLOPED BARN'S USUALLY LEAVE THIS POST ALONE AND CUT THE REST

SLOPED BARNS
USUALLY LEAVE
THIS POST ALONE
AND CUT THE REST

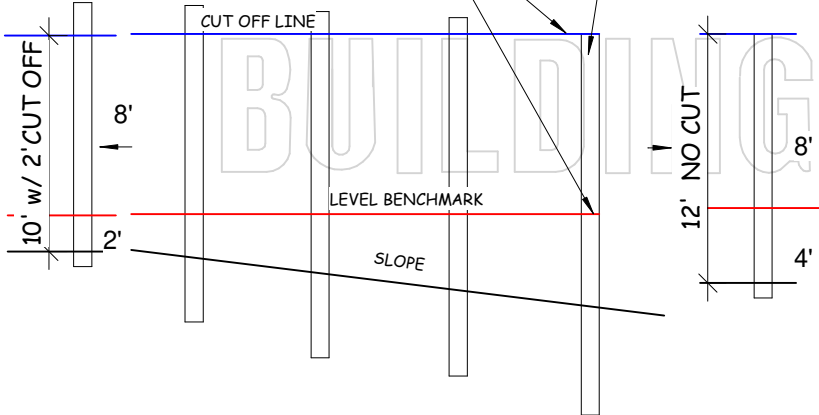

POST DETAIL

LEVEL LINE TO BE MARKED ON ALL
POST TO MEASURE UP FROM SLAB
& TOP ALL POST AT PURCHASE
EAVE HEIGHT

IF SLOPE EXISTS
EAVE HEIGHT CAN ONLY
BE AS TALL AS
SHORTEST POST

WU

IF SLOPE EXISTS
HEIGHT CAN ONLY
BE AS TALL AS
SHORTEST POST

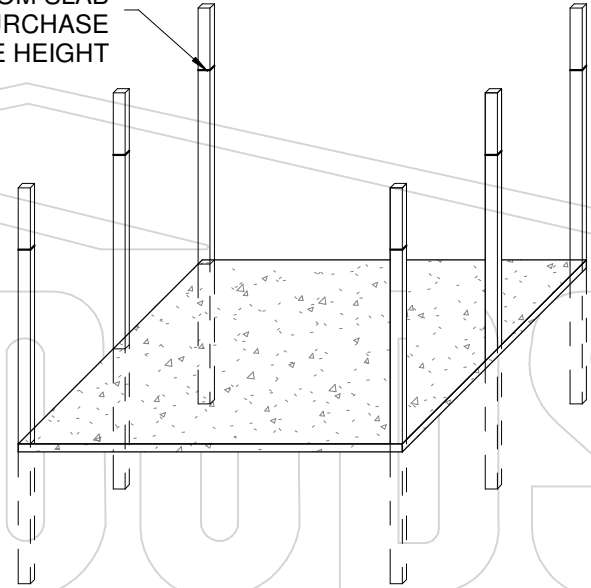

DIY INSTRUCTIONS FOR VISUAL AID ONLY
PLEASE CONSULT LOCAL BUILDING
DEPARTMENT FOR CODE SPECIFICATIONS

1240 S. BLVD. CHIPLEY FLORIDA, 32428
WEBSITE: www.backwoodsbuildings.net
PHONE NO : (850)-676-4903

BACKWOODS
BUILDINGS & TRUSS LLC

END BAY DETAIL

**ENSURE FIRST TRUSS
IS LEVEL AND PLUMB**

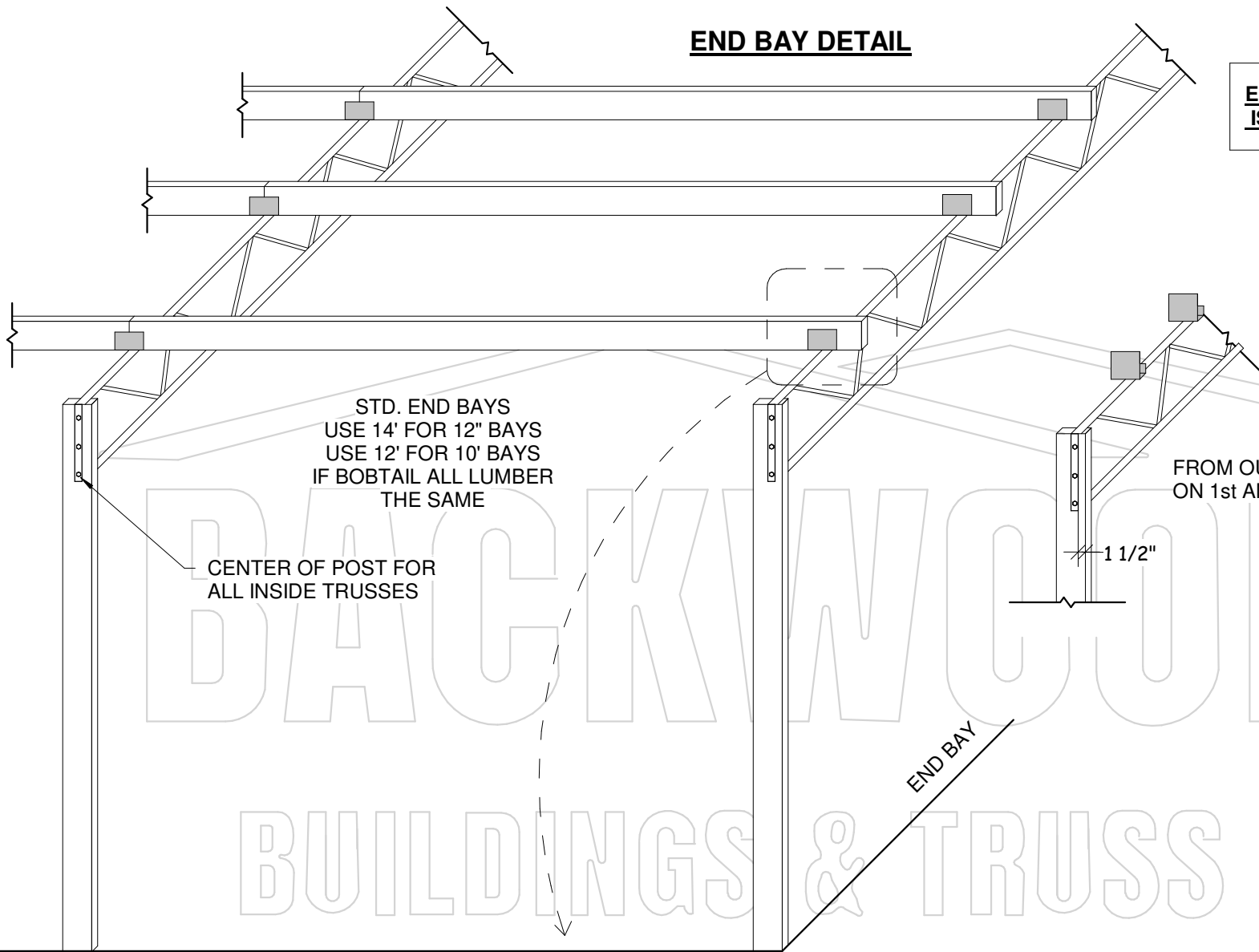

DISCLAIMER:

DIY INSTRUCTIONS FOR VISUAL AID ONLY
PLEASE CONSULT LOCAL BUILDING
DEPARTMENT FOR CODE SPECIFICATIONS

BACKWOODS BUILDINGS & TRUSS LLC

1240 S. BLVD. CHIPLEY FLORIDA, 32428
WEBSITE: www.backwoodsbuildings.net
PHONE NO : (850)-676-4903

END BAY LUMBER

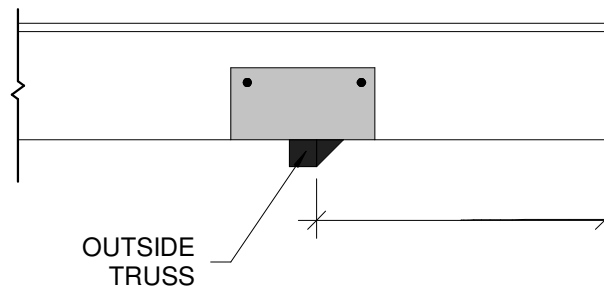

40' CUT BACK TO
11.5" FROM TRUSS
TO END OF BOARD

MEASURE 17.5" FROM OUTSIDE OF TRUSS ANGLE
& MARK BOARD TO BE CUT

BACKWOODS
BUILDINGS & TRUSS LLC

PAGE NO.

6

BOBTAIL DETAIL

ENSURE FIRST TRUSS
IS LEVEL AND PLUMB

BOBTAIL BAY LUMBER WILL ALL
BE THE SAME LENGTH

CENTER OF POST FOR
ALL INSIDE TRUSSES

PRE-CUT END BAY LUMBER
TO OUTSIDE OF POST
TYP. 10' OR 12'
NO OVERHANG

1 1/2"
FROM OUTSIDE OF CORNER
ON 1st AND LAST TRUSS

END BAY

PRE-CUT LUMBER
IN CUFFS @ CENTER BAYS

CENTER
TRUSSES

POST

OUTSIDE TRUSS

DISCLAIMER:

DIY INSTRUCTIONS FOR VISUAL AID ONLY
PLEASE CONSULT LOCAL BUILDING
DEPARTMENT FOR CODE SPECIFICATIONS

BACKWOODS BUILDINGS & TRUSS LLC

1240 S. BLVD. CHIPLEY FLORIDA, 32428
WEBSITE: www.backwoodsbuildings.net
PHONE NO : (850)-676-4903

BACKWOODS
BUILDINGS & TRUSS LLC

PAGE NO.

7

BAY DETAIL

FASCIA BOARD DETAIL

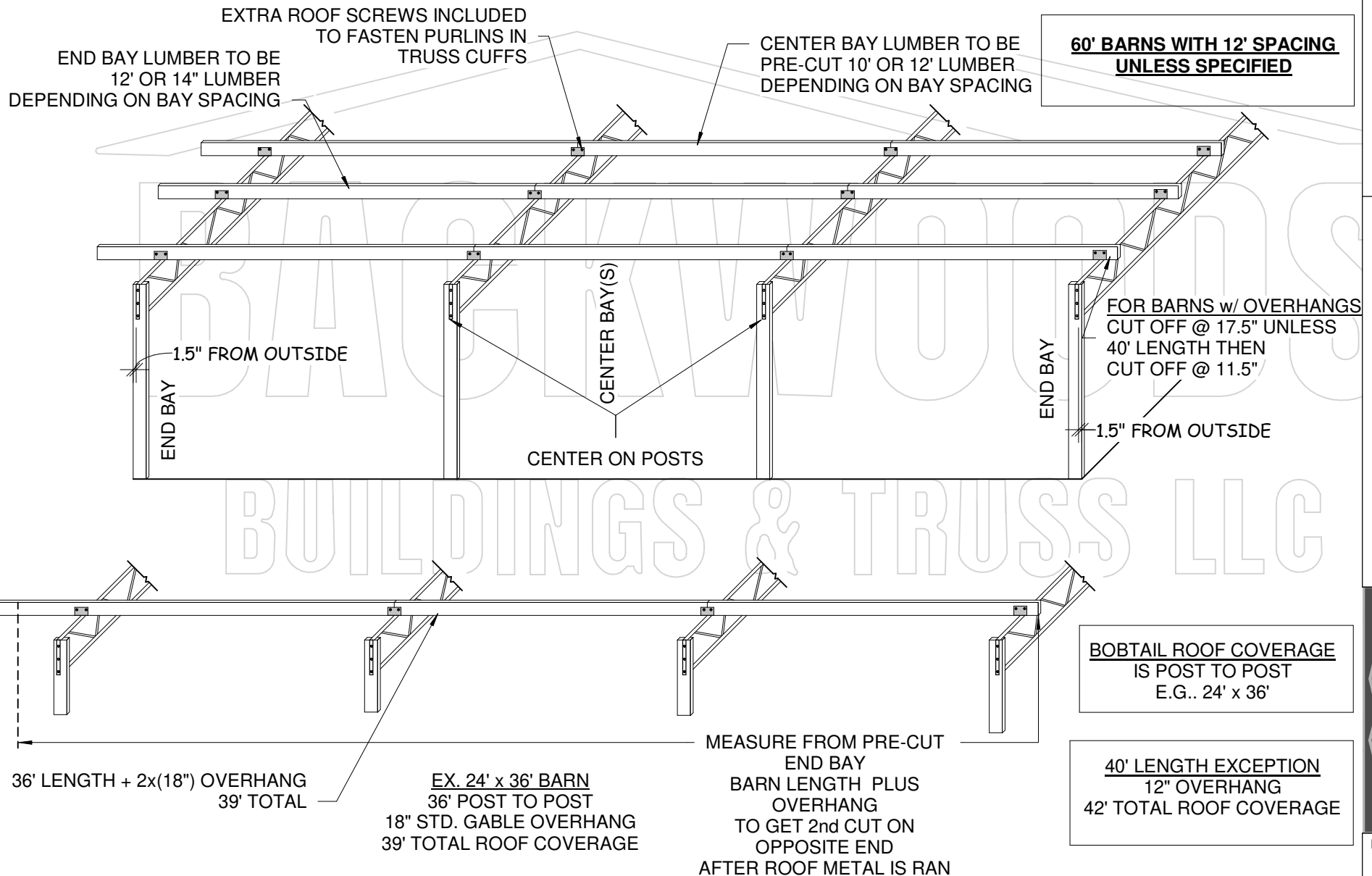

DISCLAIMER:

DIY INSTRUCTIONS FOR VISUAL AID ONLY
PLEASE CONSULT LOCAL BUILDING
DEPARTMENT FOR CODE SPECIFICATIONS

BACKWOODS BUILDINGS & TRUSS LLC

1240 S. BLVD. CHIPLEY FLORIDA, 32428
WEBSITE: www.backwoodsbuildings.net
PHONE NO : (850)-676-4903

BACKWOODS BUILDINGS & TRUSS LLC

PAGE NO.

8

ROOF DETAIL

ROOF PANELS ARE 36" WIDE
PLEASE CONFIRM PANEL COUNT
FOR BOTH SIDES ARE CORRECT
BEFORE SCREWING DOWN

SCREW PATTERN

BESIDE EA. HIGH RIB
& BOTH SIDES OF OVERLAP

#1 INTERMEDIATE AREA

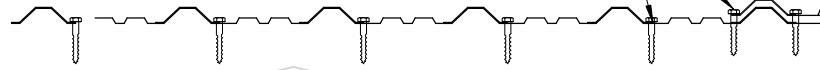

DOUBLE BESIDE
EA. HIGH RIB

#2 PEAKS & EAVES



#2

#1

#2

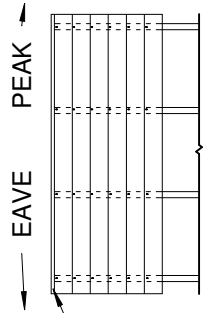

INSTALL 1st PANEL APPROX.
1" PAST FASCIA BOARD

TO ENSURE ROOF PANELS ARE
INSTALLED STRAIGHT
USE A PIECE OF BOARD ATTACHED &
EXTENDED PAST EAVE BOARDS W/ STRING LINE
2"- 4" DOWN LENGTH OF ROOF

TRIM AND FOLD END FOR DECORATION IF DESIRED

SCREW @ EA. HIGH RIB

RIDGE CAP INCLUDED AS STD. TRIM
TO BE OVERLAPPED 3"- 6"

ENSURE ROOF IS SQUARE
LENGTH 1 = LENGTH 2

PEAK

LENGTH 1

LENGTH 2

EAVES

STRING LINE TO OPPOSITE END OF GABLE

BOARD TO EXTEND PAST LAST EAVE
BOARD FOR STRING LINE

DISCLAIMER:

DIY INSTRUCTIONS FOR VISUAL AID ONLY
PLEASE CONSULT LOCAL BUILDING
DEPARTMENT FOR CODE SPECIFICATIONS

BACKWOODS BUILDINGS & TRUSS LLC

1240 S. BLVD. CHIPLEY FLORIDA, 32428
WEBSITE: www.backwoodsbuildings.net
PHONE NO : (850)-676-4903

BACKWOODS BUILDINGS & TRUSS LLC

PAGE NO.

9