

**SINGLE SLOPE POLE BARN
DIY INSTRUCTIONS**

DISCLAIMER:
 DIY INSTRUCTIONS FOR VISUAL AID ONLY
 PLEASE CONSULT LOCAL BUILDING
 DEPARTMENT FOR CODE SPECIFICATIONS

BACKWOODS BUILDINGS & TRUSS LLC
 1240 S. BLVD. CHIPLEY FLORIDA, 32428
 WEBSITE: www.backwoodsbuildings.net
 PHONE NO : (850)-676-4903

TYP. POST DETAILS

TRUSS SIZE	POST HOLE DIAMETER	POST HOLE DEPTH	CONC. lbs
6'-20'	18" dia	36"- 40"	320lbs
21'-28'	24" dia	36"- 40"	640lbs

STANDARD MATERIALS INCLUDED
 ROOF PANELS & SCREWS
 2x6 PURLINS
 1x6 FASCIA BOARD
 TRUSSES AND HARDWARE
 POST & REBAR

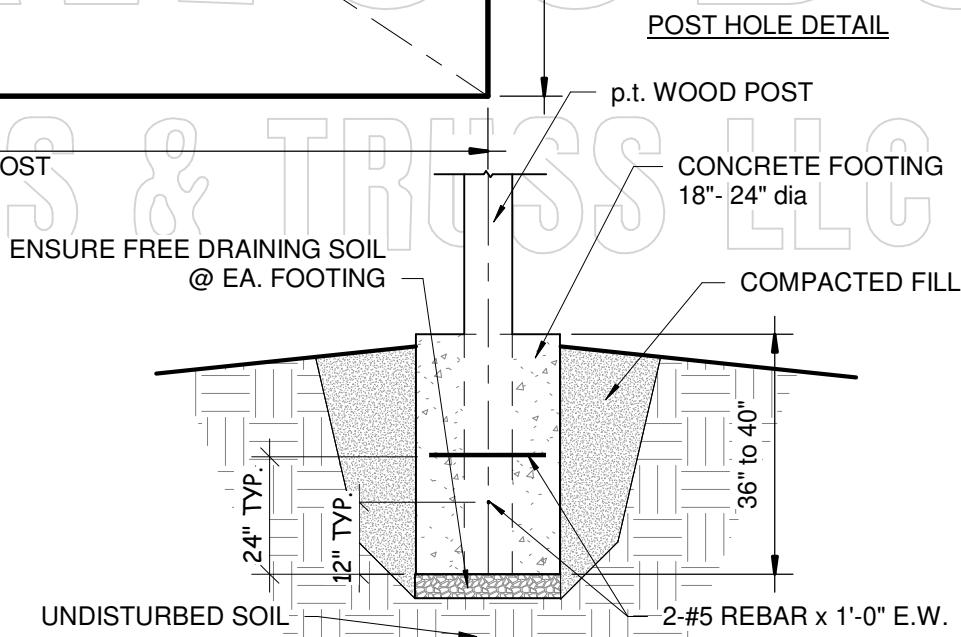

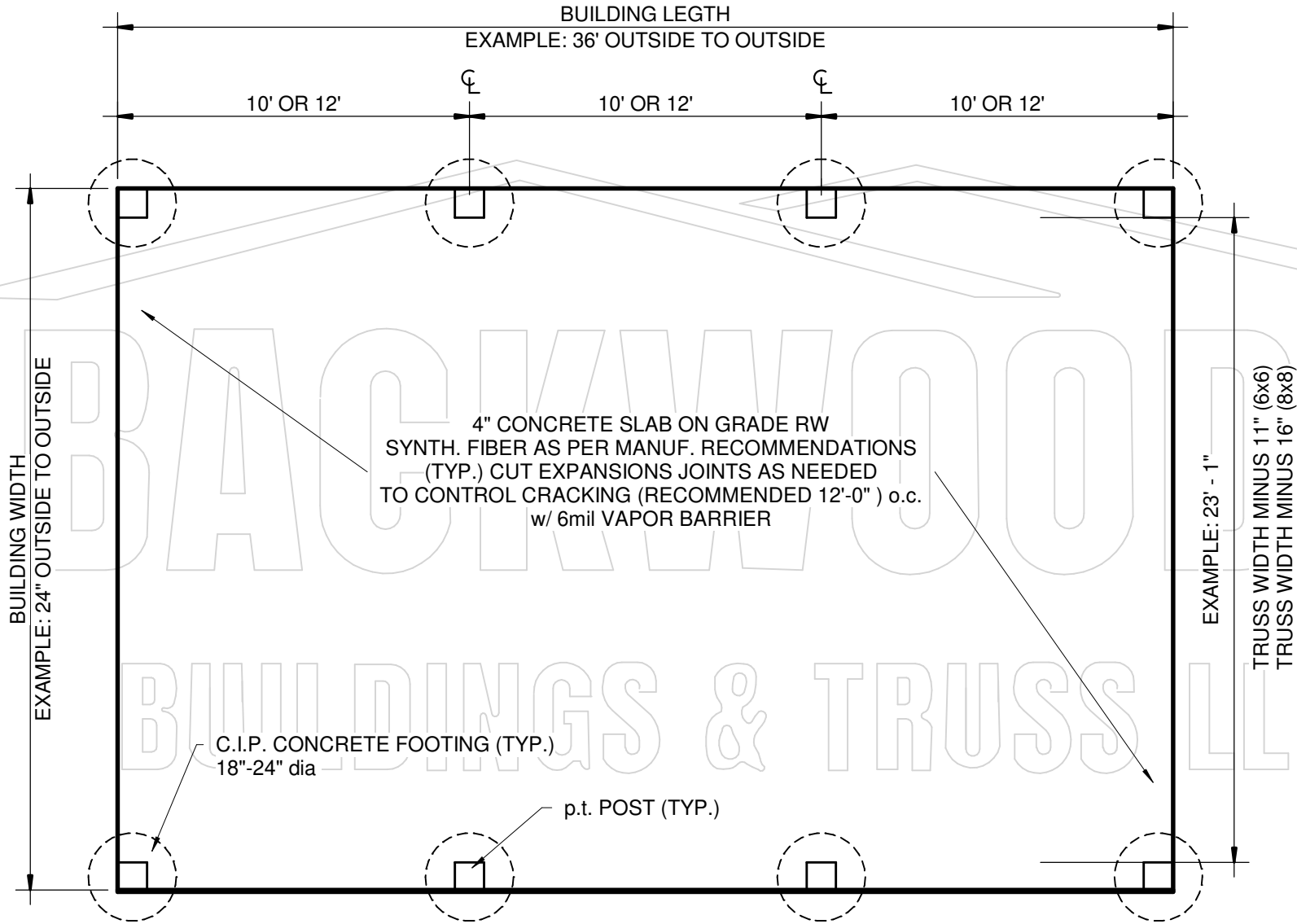

DISCLAIMER:

DIY INSTRUCTIONS FOR VISUAL AID ONLY
PLEASE CONSULT LOCAL BUILDING
DEPARTMENT FOR CODE SPECIFICATIONS

BACKWOODS BUILDINGS & TRUSS LLC

1240 S. BLVD. CHIPLEY FLORIDA, 32428
WEBSITE: www.backwoodsbuildings.net
PHONE NO : (850)-676-4903

BACKWOODS
BUILDINGS & TRUSS LLC

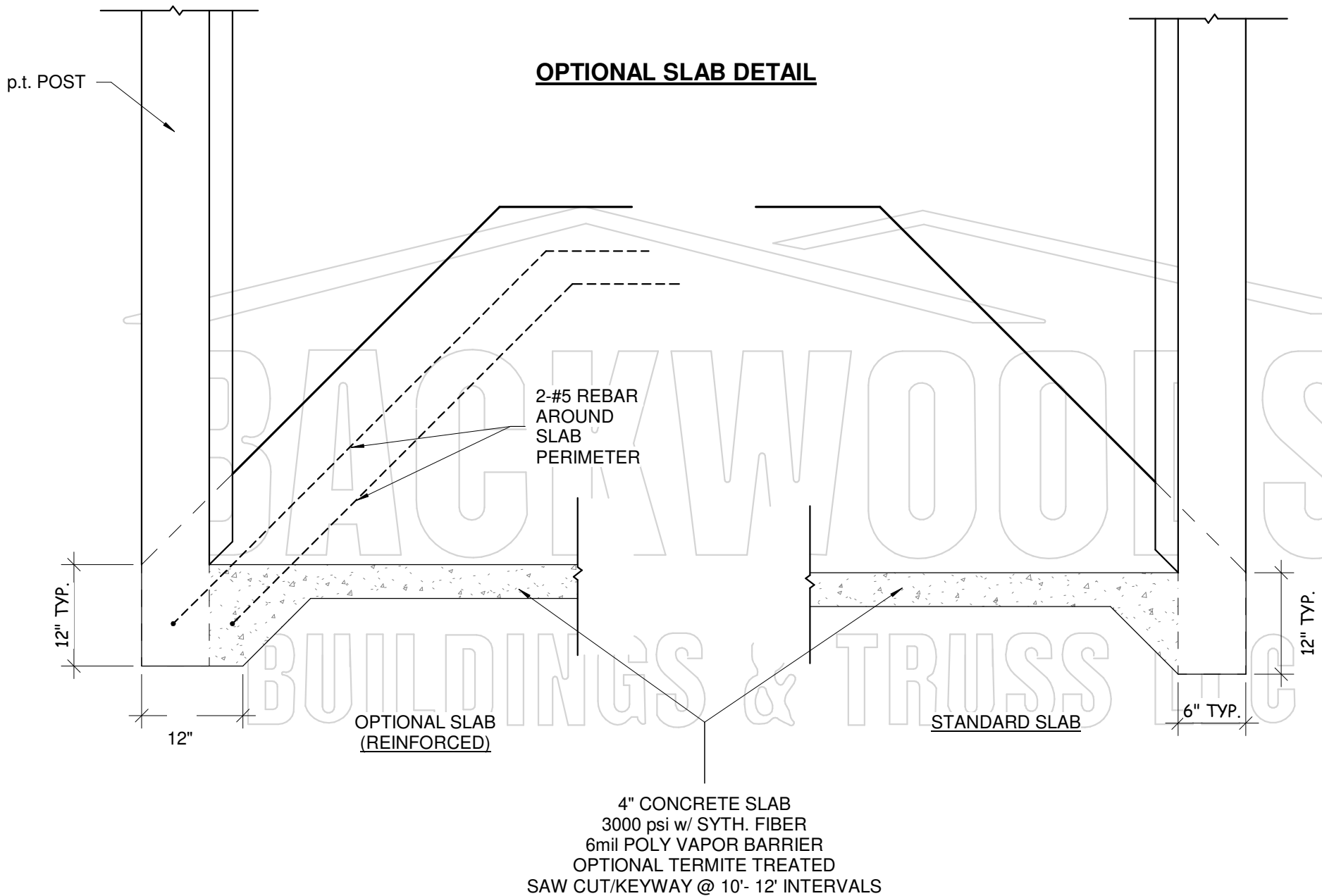

CONCRETE SLAB TO BE POURED AFTER POSTS ARE SET AND OPEN POLE BARN IS FINISHED IF POSSIBLE

DISCLAIMER:
DIY INSTRUCTIONS FOR VISUAL AID ONLY
PLEASE CONSULT LOCAL BUILDING
DEPARTMENT FOR CODE SPECIFICATIONS

BACKWOODS BUILDINGS & TRUSS LLC
1240 S. BLVD. CHIPLEY FLORIDA, 32428
WEBSITE: www.backwoodsbuildings.net
PHONE NO : (850)-676-4903

BACKWOODS
BUILDINGS & TRUSS LLC

PAGE NO.

3

NOTE:
PRE-DRILL 1/2" PILOT
HOLES FOR CARRIAGE BOLTS

16 Ga. METAL
ROOF CLIPS
(6" LONG) w/
2-#9 x 1 1/2" SCREWS
@ EA. PURLIN

1/2" CARRIAGE BOLTS
w/ WASHERS (TYP.)

UP TO 2' - 4"
O.C.

12" OVERHANG
PAST POST

6x6 p.t. POST
OR
8x8 p.t. POST

INSIDE 23'-1"

EXAMPLE 24'

TYP. TRUSS DETAILS					
TRUSS SPAN	TYP. POST SIZE	TRUSS DEPTH	TOP CHORD	WEB	TRUSS TO POST
10-20	6x6	16"	L 1.5 x 1.5 x 1/8"	L 1 x 1 x 1/8"	3- 1/2" dia CARIAGE BOLT w/ WASHERS
21-28	8x8	16"	L 2 x 2 x 3/16"	L 1.5 x 1.5 x 1/8"	3- 1/2" dia CARIAGE BOLT w/ WASHERS

DISCLAIMER:

DIY INSTRUCTIONS FOR VISUAL AID ONLY
PLEASE CONSULT LOCAL BUILDING
DEPARTMENT FOR CODE SPECIFICATIONS

BACKWOODS BUILDINGS & TRUSS LLC
1240 S. BLVD. CHIPLEY FLORIDA 32428

240 S. BLVD. CHIPLEY FLORIDA, 32428
WEBSITE: www.backwoodsbuildings.net

PHONE NO : (850)-676-4903

BACKWOODS
BUILDINGS & TRUSS LLC

PAGE NO.

LEVEL DETAIL

MEASURE FROM BENCHMARK TO GROUND
DEDUCT MEASUREMENT FROM PROPOSED
EAVE HEIGHT, REMAINDER IS MEASUREMENT UP
TO CUT POST. USE THIS MEASUREMENT ON ALL
POST TO ACHIEVE LEVEL POSTS.

MEASURE ALL CORNER POST FROM
BENCHMARK TO GROUND. IF MEASUREMENT
DIFFERS MORE THAN 12" SEE SLOPE DETAIL

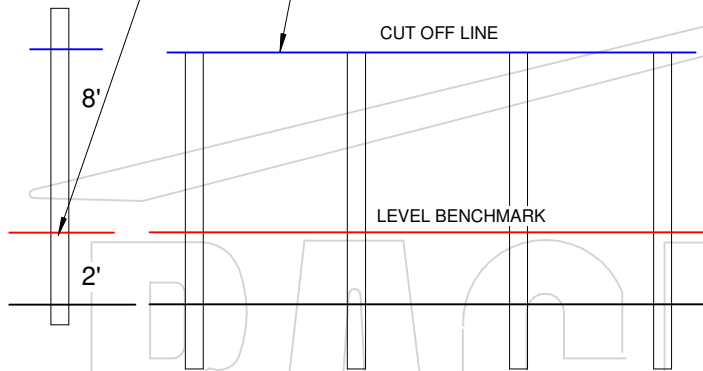

POST DETAIL

LEVEL LINE TO BE MARKED ON ALL
POST TO MEASURE UP FROM SLAB
& TOP ALL POST AT PURCHASE
EAVE HEIGHT

IF SLOPE EXISTS
EAVE HEIGHT CAN ONLY
BE AS TALL AS
SHORTEST POST

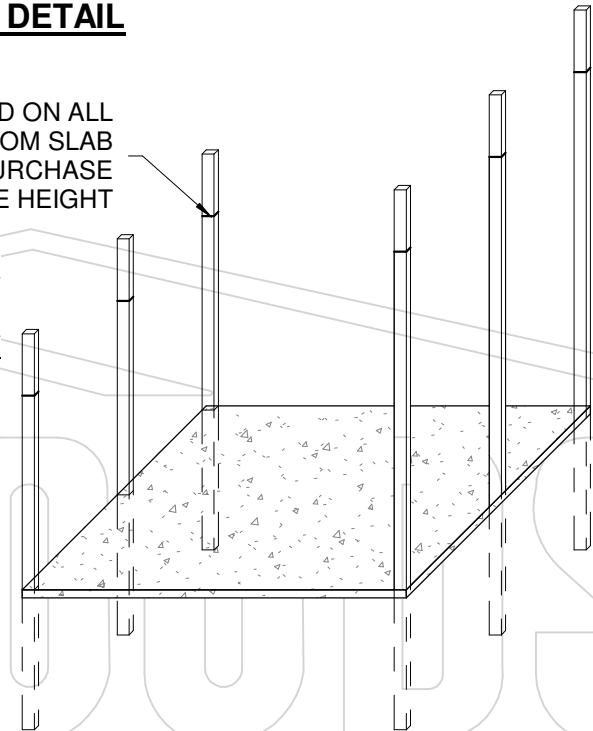

SLOPE DETAIL

MEASURE FROM BENCHMARK
TO GROUND, IF MEASUREMENT
CHANGES MORE THAN 12"
EAVE HEIGHT CAN ONLY BE AS
TALL AS POST WITH SHORTEST
MEASUREMENT FROM BENCHMARK
TO TOP OF POST

SLOPED BARNS
USUALLY LEAVE
THIS POST ALONE
AND CUT THE REST

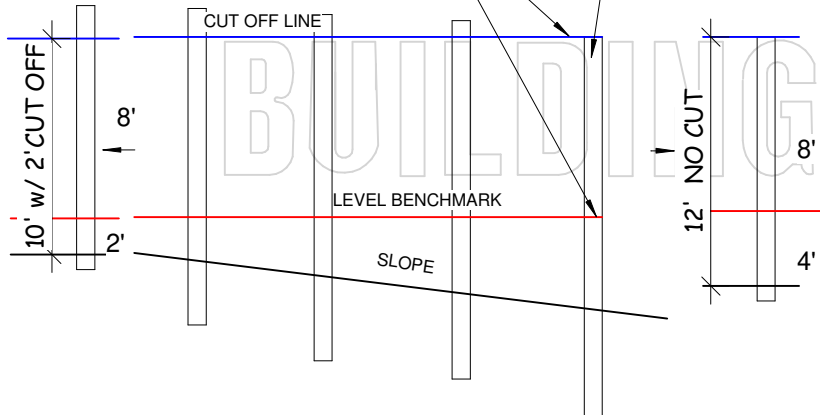

DISCLAIMER:

DIY INSTRUCTIONS FOR VISUAL AID ONLY
PLEASE CONSULT LOCAL BUILDING
DEPARTMENT FOR CODE SPECIFICATIONS

BACKWOODS BUILDINGS & TRUSS LLC

1240 S. BLVD. CHIPLEY FLORIDA, 32428
WEBSITE: www.backwoodsbuildings.net
PHONE NO : (850)-676-4903

BACKWOODS BUILDINGS & TRUSS LLC

END BAY DETAIL

**ENSURE FIRST TRUSS
IS LEVEL AND PLUMB**

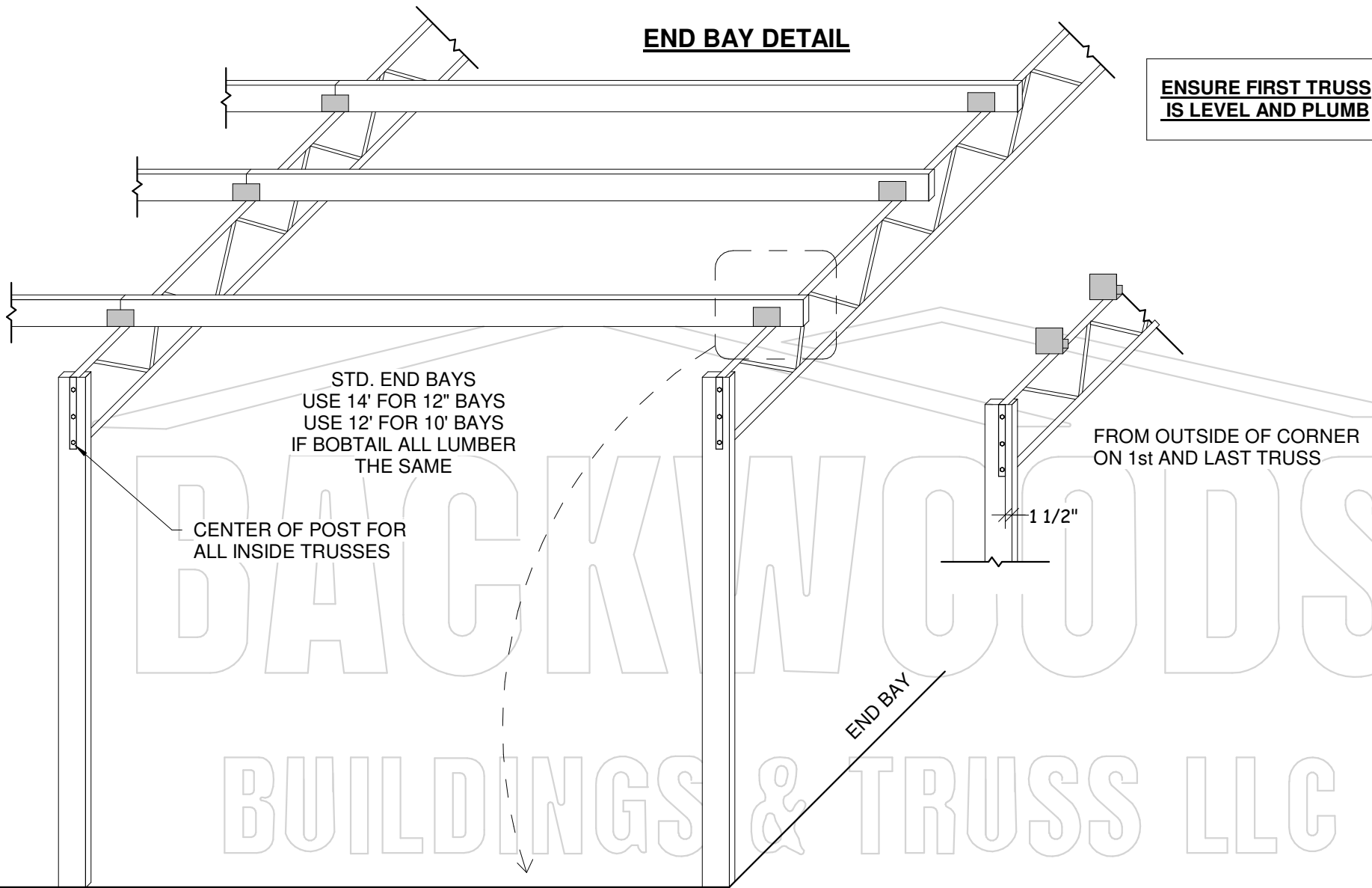

STD. END BAYS
USE 14' FOR 12" BAYS
USE 12' FOR 10' BAYS
IF BOBTAIL ALL LUMBER
THE SAME

CENTER OF POST FOR
ALL INSIDE TRUSSES

FROM OUTSIDE OF CORNER
ON 1st AND LAST TRUSS

1 1/2"

END BAY

END BAY LUMBER

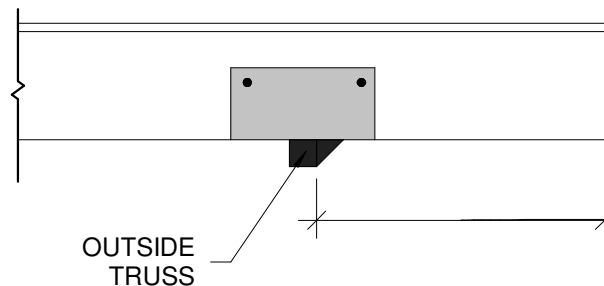

40' CUT BACK TO
11.5" FROM TRUSS
TO END OF BOARD

MEASURE 17.5" FROM OUTSIDE OF TRUSS ANGLE
& MARK BOARD TO BE CUT

DISCLAIMER:

DIY INSTRUCTIONS FOR VISUAL AID ONLY
PLEASE CONSULT LOCAL BUILDING
DEPARTMENT FOR CODE SPECIFICATIONS

BACKWOODS BUILDINGS & TRUSS LLC

1240 S. BLVD. CHIPLEY FLORIDA, 32428
WEBSITE: www.backwoodsbuildings.net
PHONE NO : (850)-676-4903

BACKWOODS
BUILDINGS & TRUSS LLC

PAGE NO.

6

BOBTAIL DETAIL

ENSURE FIRST TRUSS
IS LEVEL AND PLUMB

BOBTAIL BAY LUMBER WILL ALL
BE THE SAME LENGTH

CENTER OF POST FOR
ALL INSIDE TRUSSES

PRE-CUT END BAY LUMBER
TO OUTSIDE OF POST
TYP. 10' OR 12'
NO OVERHANG

1 1/2"
FROM OUTSIDE OF CORNER
ON 1st AND LAST TRUSS

END BAY

PRE-CUT LUMBER
IN CUFFS @ CENTER BAYS

CENTER
TRUSSES

POST

OUTSIDE TRUSS

DISCLAIMER:

DIY INSTRUCTIONS FOR VISUAL AID ONLY
PLEASE CONSULT LOCAL BUILDING
DEPARTMENT FOR CODE SPECIFICATIONS

BACKWOODS BUILDINGS & TRUSS LLC

1240 S. BLVD. CHIPLEY FLORIDA, 32428
WEBSITE: www.backwoodsbuildings.net
PHONE NO : (850)-676-4903

BACKWOODS
BUILDINGS & TRUSS LLC

PAGE NO.

7

BAY DETAIL

FASCIA BOARD DETAIL

1x6x14' p.t. FASCIA BOARD INCLUDED

STD. PITCH 6'-28' 1/12

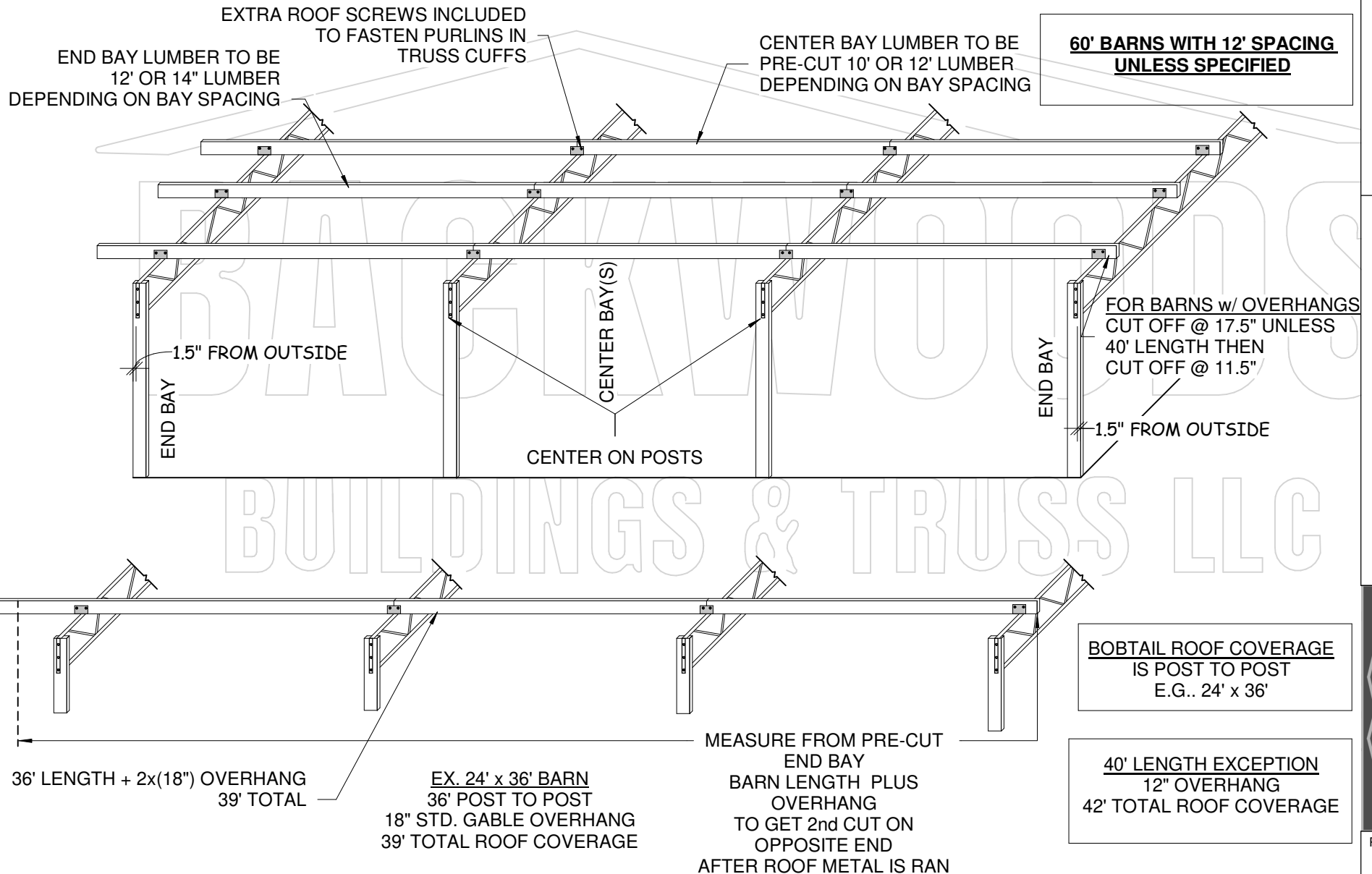

DISCLAIMER:

DIY INSTRUCTIONS FOR VISUAL AID ONLY
PLEASE CONSULT LOCAL BUILDING
DEPARTMENT FOR CODE SPECIFICATIONS

BACKWOODS BUILDINGS & TRUSS LLC

1240 S. BLVD. CHIPLEY FLORIDA, 32428
WEBSITE: www.backwoodsbuildings.net
PHONE NO : (850)-676-4903

BACKWOODS
BUILDINGS & TRUSS LLC

PAGE NO.

8

ROOF DETAIL

ROOF PANELS ARE 36" WIDE
PLEASE CONFIRM PANEL COUNT
FOR BOTH SIDES ARE CORRECT
BEFORE SCREWING DOWN

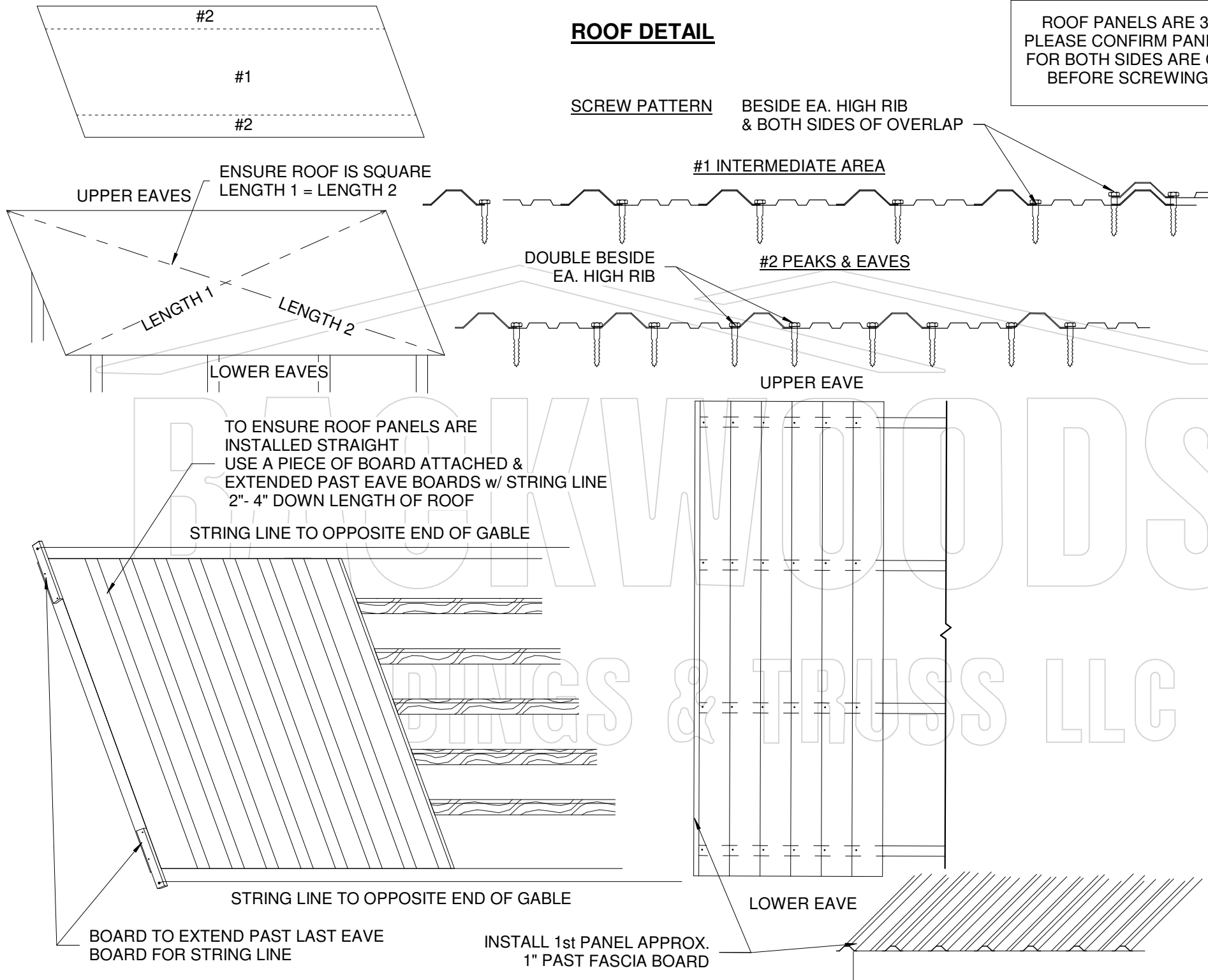

DISCLAIMER:

DIY INSTRUCTIONS FOR VISUAL AID ONLY
PLEASE CONSULT LOCAL BUILDING
DEPARTMENT FOR CODE SPECIFICATIONS

BACKWOODS BUILDINGS & TRUSS LLC

1240 S. BLVD. CHIPLEY FLORIDA, 32428
WEBSITE: www.backwoodsbuildings.net
PHONE NO : (850)-676-4903

BACKWOODS BUILDINGS & TRUSS LLC

PAGE NO.

9